



This is a pump used for domestic hot water boosting. Recommended for use with low pressure or gavity fed domestic pressure system.

The pump is characterised by -

- Automatic operation controlled by flow switch
- Circulation body materials suitable for potable water
- 1 speed operation
- Flows to 30 l/min
- Heads to 9m

Liquid temperature: Maximum 60°C

Materials: Pump body: Stainless Steel 304

Impeller: Corrosion resistant composite PPO

Back Plate and Rotor Can: Stainless Steel 304

Unions: Stainless Steel 304

Installation: Maximum ambient temperature: 40°C

Maximum Operating Pressure: 6 bar

Port spacing: 160mm

Port size: 3/4" BSPM

(1/2" BSPM if used with supplied unions)

Electrical Data: 230V

Mains Frequency: 50Hz

Power consumption speeds: 120W

Motor: Continuous

Motor type: Canned rotor

Ingress Protection: IP42

Power cable: 1m

Bianco Pumpz 2 Year Warranty

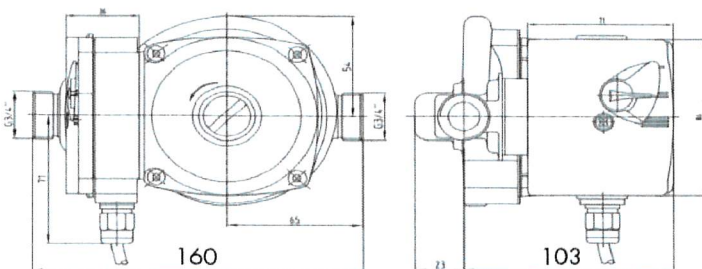
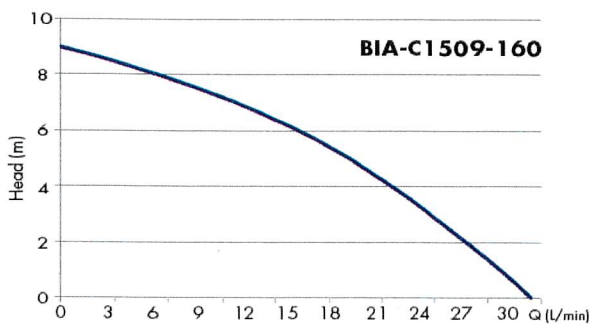

Also available
BIA-C2060-150
BIA-C2580-180
BIA-ICIRC150