

In compliance with EN12050-3

Measures in millimeters

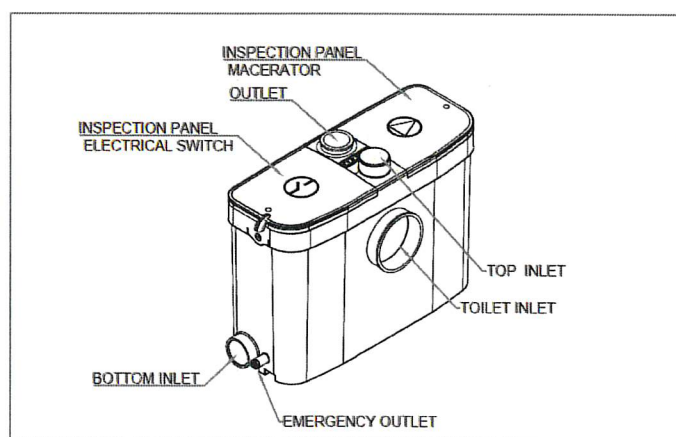
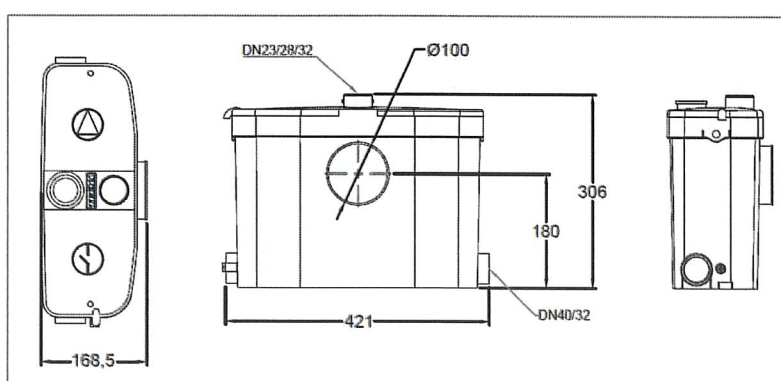

Assistance

TECMA Srl

info@tecma.eu

+39 0744 709071

www.thetfordresidential.com

serbatoio all'interno del vano pompa.



Nel caso in cui gli ingressi ausiliari non vengano utilizzati assemblare il relativo tappo di chiusura (Fig.4).

2. INSTRUCTIONS FOR INSTALLATION AND USE

2.1. Warnings and precautions

- If the electricity supply fails, do not use the devices connected to the appliance.
- It is recommended to use a power outlet for the exclusive use of the appliance.
- The appliance can discharge only faeces, toilet paper and acid fatty and hot water (up to 80C°). Do not dispose unsuitable objects, hygienic articles or fibrous material that might damage the pump
- Check that any device connected to the appliance is not leaking, as in that case the pump will operate uselessly. Furthermore, in the event of a failure in the power supply, water leakage from some device could flow back up and might then overflow.
- If the bathroom is not used for a long period, it is recommended to close the main water supplies.
- This equipment can be used by children aged 8 and up if under surveillance, or if they have received the instructions regarding a safely usage of device and if they understand dangers involved. Cleaning and maintenance by the user should not be performed by children unless they are older than 8 years and operate under surveillance. Keep any power cable out of reach of children under the age of 8 years.
- The equipment can be used by people with reduced physical, sensory or mental capabilities or lack of experience and knowledge if they have supervision or if they have received instructions regarding the use in safety of the device and understand dangers involved.
- Children should not play with the equipment.

2.2. Maintenance | Service

It is strictly recommended to carefully read this warning and precautions guidelines, before any maintenance and service operation on the product.

The Saniexpert, Mod. 450, consists of a water collection unit permanently fixed to the toilet, and / or to other utilities, containing the engine components.

The maintenance is a simple operation executable in a few steps.

Removal of potential obstructions in the macerating chamber:

1. Unplug the power cord.
2. Unscrew the cap with the pump symbol as shown in Fig. 5.1
3. Remove the cap as shown in Fig. 5.1
4. Unscrew macerator chamber cap as shown in Fig. 5.2
5. Turn and remove macerator chamber cap as shown in Fig. 5.2
6. Remove clogging parts using pliers Fig. 5.3



7. Once the maintenance is completed reassemble the unit following inverse procedure

NB: DO NOT REMOVE OR REPLACE THE OIL PRESENT IN THE ENGINE. DO NOT TAMPER THE MOTOR HOUSING OR THE DRAINAGE CAP. This type of action could jeopardize the unit and lose coverage by guarantees.

2.3. Installation and use

Saniexpert, Mod. 450, consists of a box that incorporates a pump that can automatically grind and expel acid, fatty hot water (up to 80°C) faeces and toilet paper through a . 28/32 or 40 mm diameter pipe to the nearest sewer.

It may be used to collect and pump under pressure (refer to the performance- related specifications graph) the discharges of the sanitary fittings located in both the bathroom (EN-12050-3 EN-12050-4) or the kitchen, including washing machine, dishwasher, and any other device that needs to discharge waste water.

It is mandatory to install the non-return valve which, is included in the package.

In accordance with EN-12050-3 and EN-12050-4, if the macerator collects waste water (toilet), only one washbasin and/or one bidet and/or one shower may also be connected.

The Saniexpert, Mod.450, can not be installed to appliances, such as washing machine and dishwasher, if connected to the toilet.

In cases where it is not possible to interrupt the inflow into the product during normal operation, the installation shall be equipped with a stand-by pumping device of the same capacity, which starts automatically when necessary.

The installation shall be made in compliance with the prescription of the European Standard EN 12056-4.

Fix the water tank unit with two crew plugs (Ø 3,5 mm) or similar, using the fixing holes.

Saniexpert, Mod. 450, can be connected to any type of toilet having a wall discharge in compliance with European standards.

It is connected by inserting the toilet discharge into the rubber coupling on the tank and fixing it with the clamp supplied (Fig. 2.2).

The outlet is connected to the top side (Fig 2.3) and other units of bathroom or kitchen equipment are connected to the short sides of the appliance (Fig. 2.4)

It is recommended not to connect to Saniexpert, Mod. 450, more than 1 appliance operating potentially continuously (es. no more than 1 shower).

N.B.: The shower plate and bathtub must be at least 10 cm above floor level (Fig. 3).

All sanitary equipment connected must allow the interruption of water flow.

Saniexpert, Mod. 450, is equipped with an activated carbon filter for the ventilation of the tank inside the pump compartment.

In the event that the auxiliary inlets are not used, assemble the relative closing plug (Fig.4)